

Software Enhancement Modules (SEMs) unlock advanced features within CyberAudit-Web Enterprise software that provide specific functionality. Each SEM can be purchased individually, enabling CyberAudit-Web Enterprise customers to pay for only the features they need. Available SEMS include:

Location Graphics Module (CAW-M01)

The Location Graphics module opens a visual interface tool that allows CyberLocks and Communicators to be graphically “placed” on drawings, pictures or maps (JPEG or TIFF compatible). In particular, this module helps large and geographically spread-out CyberLock deployments to improve tracking and locating of locks and communicators.

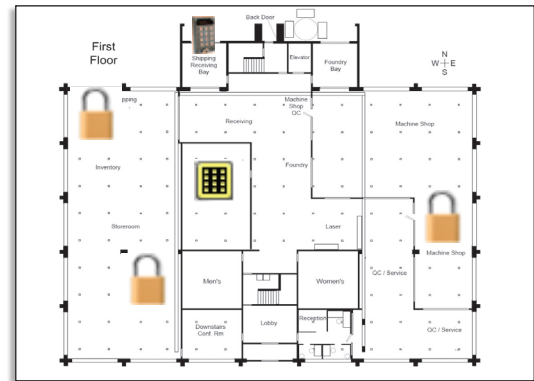

Door & I/O Support Module (CAW-M02)

The Door & I/O software module adds software features required to manage all the functionality the Door & I/O hardware module brings to a Flex System installation. In addition to managing individual access rights to each door, Request-to-Exit (RTE) events are recorded, doors can be set to automatically unlock and relock at specified times, door sensors are monitored, and alarms can be triggered if a door is forced or left open after a specified amount of time.

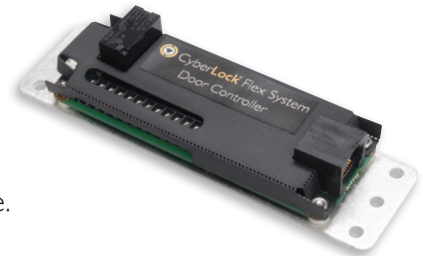

Key Security Enhancement Pack Module (CAW-M03)

The Key Security Enhancement Pack includes three security features. The first is an option that makes the first key of a multi-key operation the sole key able to open a CyberLock within an eight-second window. The second adds a Temporary Activation option that enables activating an expired CyberKey for five minutes by touching a selected CyberLock or CyberPoint. The third feature provides an option to limit Temporary Activation and One-Time Use settings to an 8-second window.



For more information about the SEM feature packs please contact Videx Sales at 541-738-5500 or sales@videx.com.



1105 N.E. Circle Blvd., Corvallis, OR 97330
541-738-5500 • Fax 541-738-5501 • www.cyberlock.com • sales@videx.com